

OPERATING SPECIFICATIONS

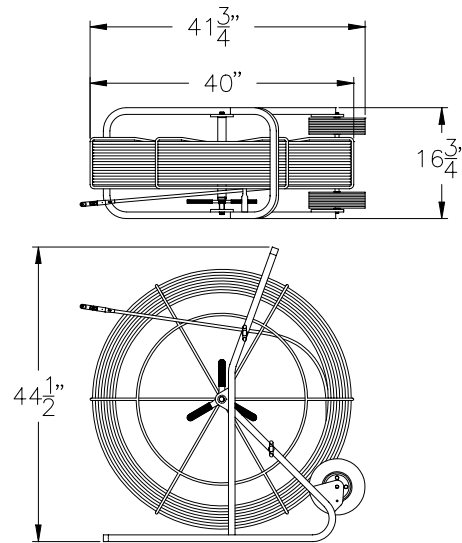

SERIES 56000 RUF ROD

1. The duct rodder is intended for feeding through existing ductwork and pulling back a pull tape or pull rope.



Part Number	Rod Length	Rod Diameter	Core Diameter	Min Bend Radius	Accessory Thread	Net Weight
56000-400	400 ft	0.430" 10.9 mm	0.315" 8.0 mm	16" 405 mm	3/8"-16	71 lb 32.2 kg
56000-500	500 ft	0.430" 10.9 mm	0.315" 8.0 mm	16" 405 mm	3/8"-16	82 lb 37.1 kg
56000-600	600 ft	0.430" 10.9 mm	0.315" 8.0 mm	16" 405 mm	3/8"-16	92 lb 42 kg
56000-700	700 ft	0.430" 10.9 mm	0.315" 8.0 mm	16" 405 mm	3/8"-16	103 lb 46.7 kg
56000-800	800 ft	0.430" 10.9 mm	0.315" 8.0 mm	16" 405 mm	3/8"-16	119 lb 54.0 kg
56000-900	900 ft	0.430" 10.9 mm	0.315" 8.0 mm	16" 405 mm	3/8"-16	124 lb 56.2 kg
56000-1000	1000 ft	0.430" 10.9 mm	0.315" 8.0 mm	16" 405 mm	3/8"-16	157 lb 71.2 kg
56000-1100	1100 ft	0.430" 10.9 mm	0.315" 8.0 mm	16" 405 mm	3/8"-16	145 lb 65.8 kg
56000-1200	1200 ft	0.430" 10.9 mm	0.315" 8.0 mm	16" 405 mm	3/8"-16	155 lb 70.3 kg
56000-1300	1300 ft	0.430" 10.9 mm	0.300" 7.6 mm	16" 405 mm	3/8"-16	166 lb 75.3 kg
56000-1400	1400 ft	0.430" 10.9 mm	0.300" 7.6 mm	16" 405 mm	3/8"-16	176 lb 79.8 kg
56000-1500	1500 ft	0.430" 10.9 mm	0.300" 7.6 mm	16" 405 mm	3/8"-16	187 lb 84.8 kg

Dimensions and weights subject to change without notice.

For Standard Rodder units that do not include accessories, add "X" to the part number.